

LOCATION MAP OF SY NO-56/3,56/4, 56/5,56/6 OF HALANAYAKANAHALLI VILLAGE, VARTHUR HOBLI, BANGALORE EAST

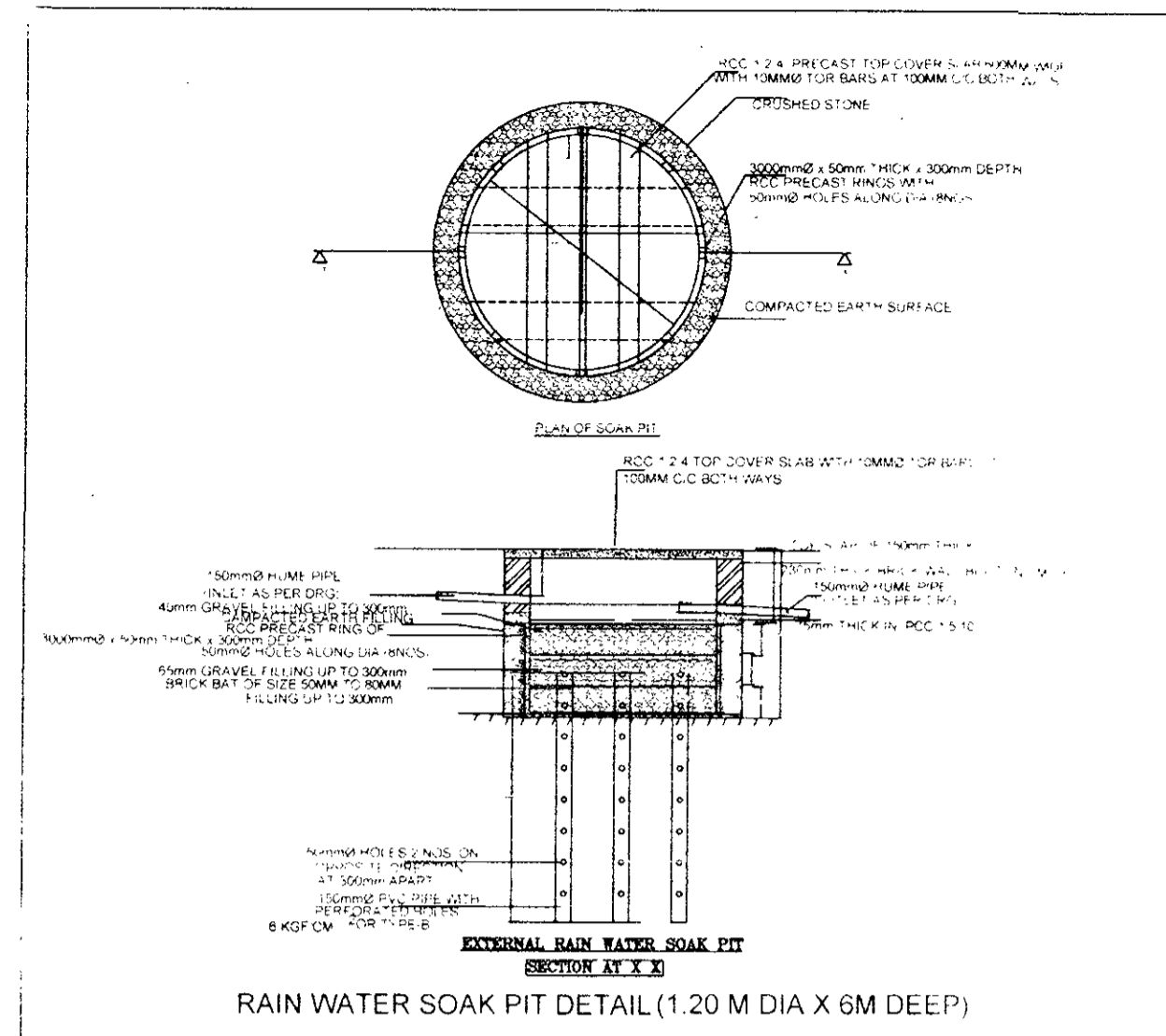

RAIN WATER SOAK PIT DETAIL (1.20 M DIA X 6M DEEP)

SY NO.56/8

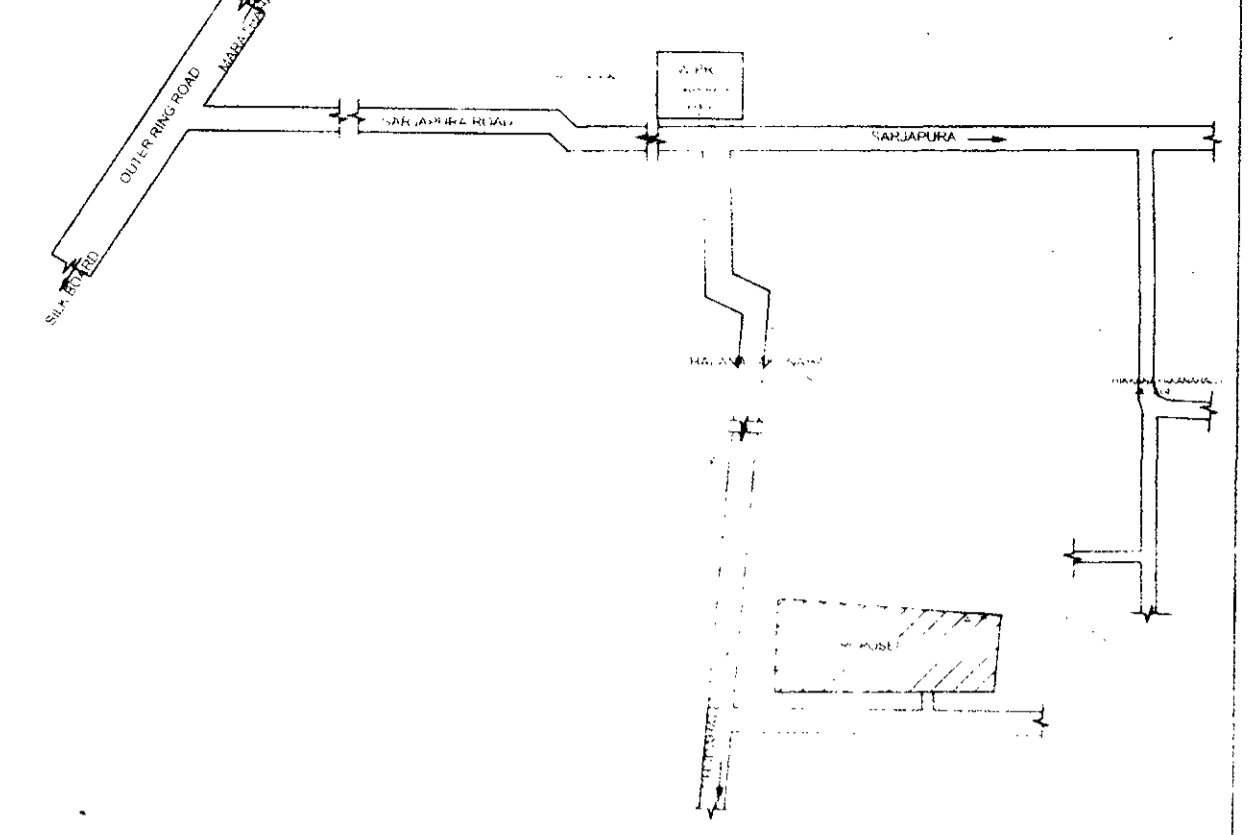

LAND USE ANALYSIS			
TOTAL AREA = 11 580.14 Sq.m = 2 Acre 34.46 Guntas			
Sl. No	LAND USE	AREA(SQ.MT)	%
1)	RESIDENTIAL	6360.96	54.93%
2)	PARK	1751.96	15.13%
3)	UTILITIES	103.02	0.89%
4)	ROAD	3364.18	29.05%
TOTAL		11,580.14	100%

PLOT DETAILS			
SITE NO	DIMENSIONS	TOTAL NO	AREA (Sq. M)
10,11,19,20,21,24,25,26,29,30,31,41,42,43,44,45,46,47,48,49,50,51,52,53	9.14M x 12.19M	24	2673.99
18	9.21M x 12.19M	01	112.27
27,28	11.96M x 12.19M	02	291.56
2, 3	9.14M x 14.90M	02	272.37
1	13.80M x 14.90M	01	206.62
9	16.61M x 12.19M	01	199.28
8	15.61M x 15.24M	01	237.89
6,7,14,15,16	9.14M x 15.24M	05	996.48
17	9.21M x 15.24M	01	140.36
4,5,12,13,22,23,32,33,34,35,36,37,38,39,40	ODD SITES	15	1640.15
TOTAL		53	6360.96

ARCHITECTS
MALLIKA P.V
CA NO -CA / 2005 / 36026
REG NO -BCC/BL-3 0/A-1724/ 07-08

OWNERS
[Signature]
DEVELOPERS
M/s. SHIVAKAR DEVELOPERS PVT LTD.
#10, VITTAL MALYA ROAD,
BANGALORE-560001

TITLE
PROPOSED RESIDENTIAL LAYOUT AT SY NO - 56/3, 56/4, 56/5,56/6 OF HALANAYAKANAHALLI VILLAGE VARTHUR HOBLI BANGALORE EAST

SURVEY CONSULTANTS
UNITED SURVEY ENGINEERS
LAND SURVEY ENGRG & MAPPING SERVICES
#10/2, 1st Floor, 1st Stage, 2nd Cross, Bangalore-560005
M.S. No. 44285 / 2015 / B.E.C.
P. No. 10/2, 1st Floor, 1st Stage, 2nd Cross, Bangalore-560005

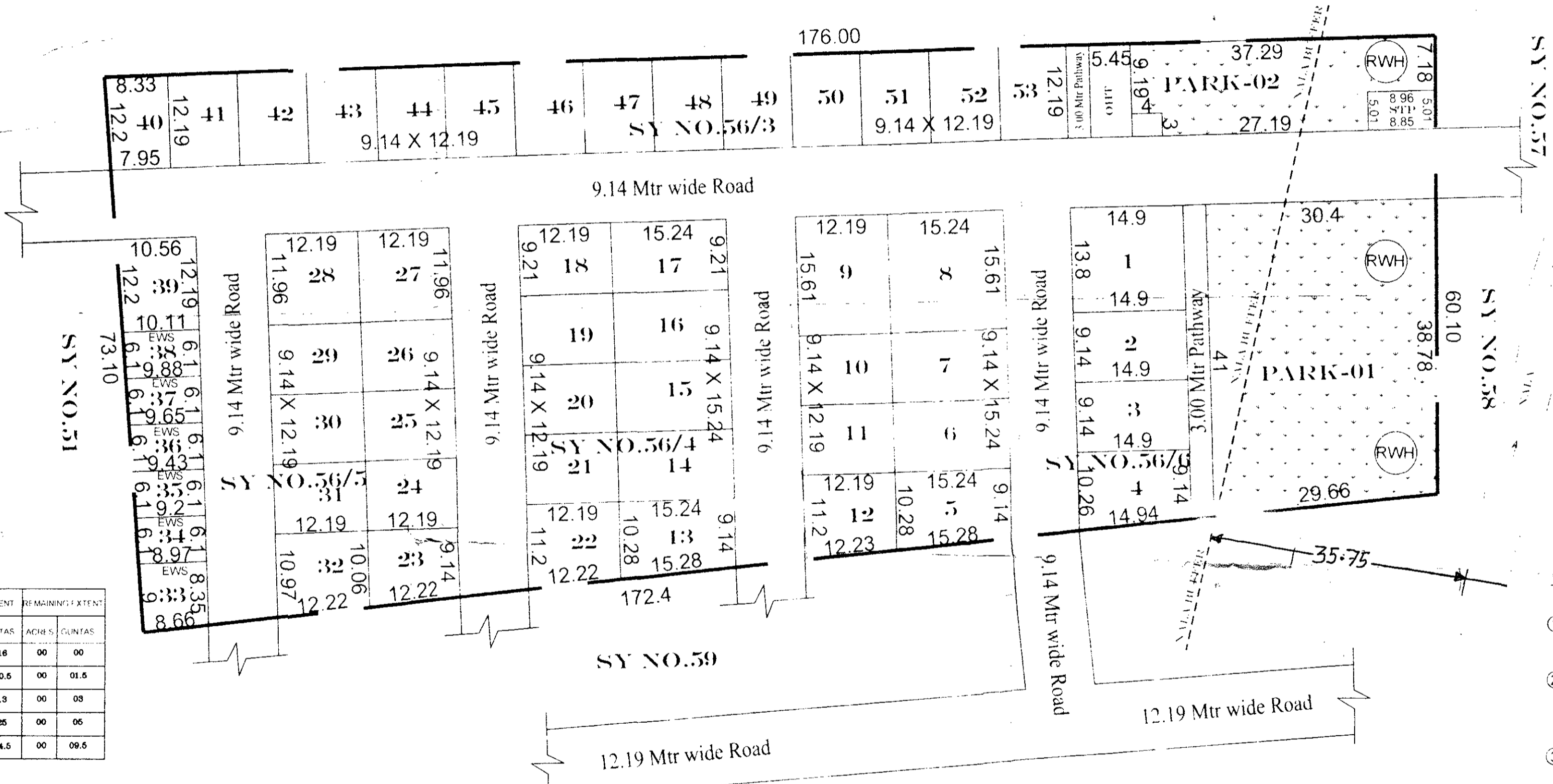

Sl. No	SURVEY NO	TOTAL EXTENT (ACRES / GUNTAS)	PLANNING EXTENT (ACRES / GUNTAS)	REMAINING EXTENT (ACRES / GUNTAS)
1	56/3	01 18 00 00	01 18 00 00	00 00 00 00
2	56/4	00 22 00 00	20.5 00 01.5	00 03 00 00
3	56/5	00 18 00 00	13 00 05	00 05 00 00
4	56/6	00 30 00 00	25 00 05	00 05 00 00
Total		03 04 00 00	34.5 00 09.5	

PARK AREA DETAILS		
Sl. No	UTILITY	AREA(Sq.m)
01	PARK-01	1751.96
02	PARK-02	432.00
TOTAL		1751.96

UTILITY		
Sl. No	UTILITY	AREA(Sq.m)
01	OUT TO YARD & STD	103.02
TOTAL		103.02

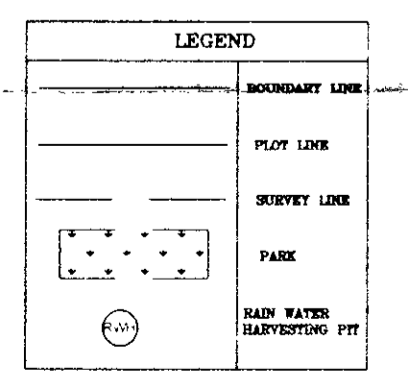

- NOTE:-**
- The Residential Layout is Approved Vide Resolution No. 64/2018 Dated-16/3/2018
 - The Applicant has Remitted Charge of Rs - 8 72 510/- Only Vide Challan No. 118 Dated 16/08/2018
 - The Applicant has to Abide by the Conditions Imposed in the Work order
 - The Work order issued Vide No. BDA/TPM/PRL/21/2017/18/ 138 /2018-19 Dated 16/08/2018

SANCTIONING AUTHORITY						
Town Planner BDA <i>[Signature]</i> 10/08/2018	Asst. Director(E) BDA <i>[Signature]</i> 01/08/2018	Dy. Director(E) BDA <i>[Signature]</i> 12	Jt. Director(E) BDA <i>[Signature]</i> 1/8	Addl. Director BDA <i>[Signature]</i> 2/4	T.P.M/c BDA <i>[Signature]</i> 3/4	Commissioner BDA <i>[Signature]</i>