

TOTAL SITE AREA - 22,510.32 SMT(5A-22.5G)
 KARAB AREA - 75.87 SMT (0 A- 0.75G)
 NET SITE AREA - 22,434.44 SMT (5A-21.75G)

LANDUSE ANALYSES

LANDUSE	AREA IN SMT	PERCENTAGE
RESIDENTIAL	12,001.35	53.50%
PARK & OPENSACE	3,485.21	15.53%
ROADS	6,947.88	30.97%
TOTAL	22,434.44	100.00%

SITE ANALYSES

SITE DIMENSION	NOs.
9.14 X 12.19	06
9.14 X 13.76	03
9.14 X 15.24	16
9.14 X 16.76	15
EWS	09
Odd Sites	38
TOTAL	87

BANGALORE DEVELOPMENT AUTHORITY
TOWN PLANNING SECTION

Residential Layout plan in Sy .No.44(p)
,55,56(P),57/1(P) & 60(P) of Gattahalli
Village, Sarjapura Hobli, Bangalore.



Scale- 1:1500

OWNER'S /GPA HOLDERS SIGNATURE :-

(Signature)
A.RAMAREDDY

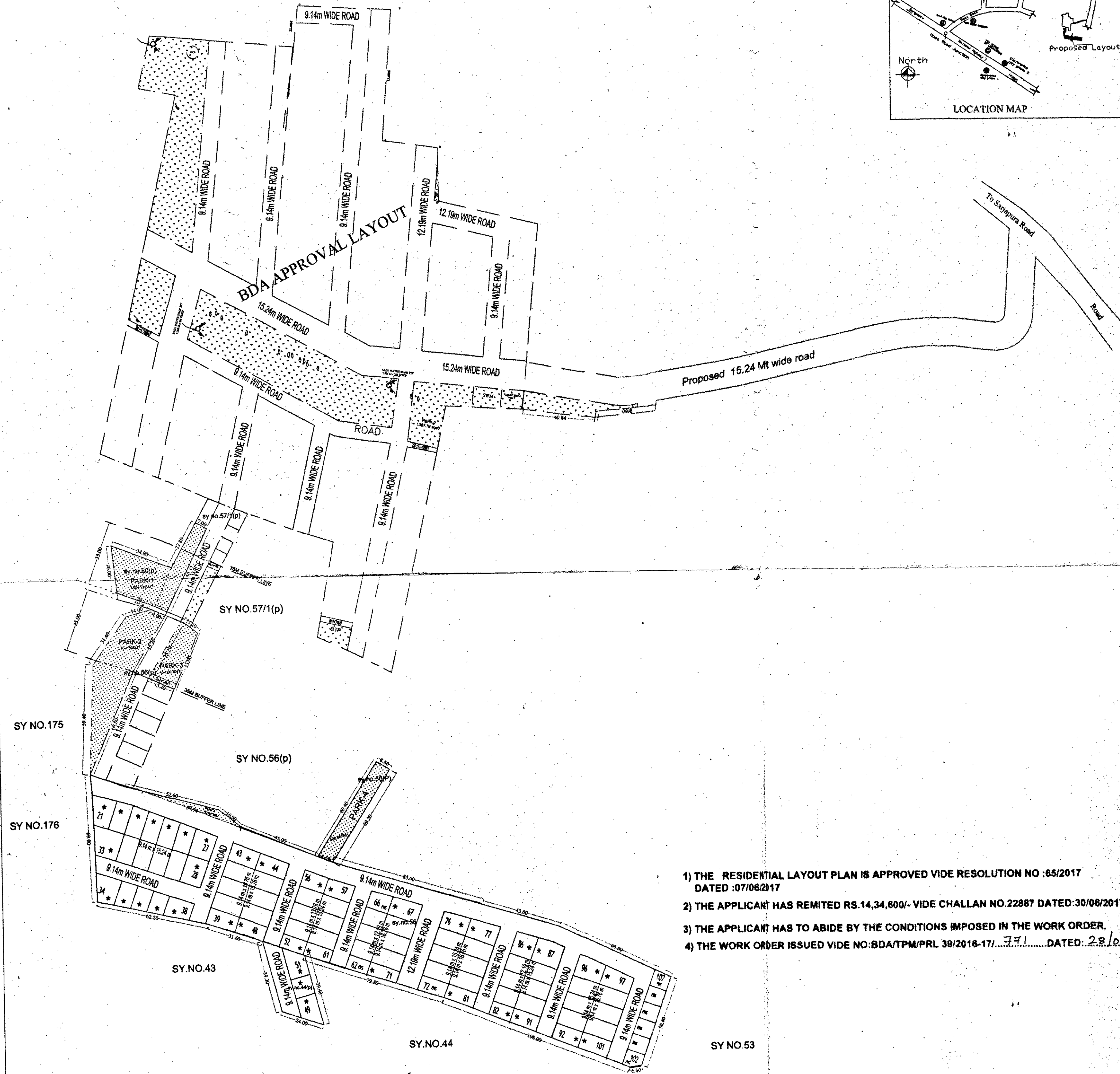

- 1) THE RESIDENTIAL LAYOUT PLAN IS APPROVED VIDE RESOLUTION NO : 65/2017 DATED :07/06/2017
- 2) THE APPLICANT HAS REMITED RS.14,34,600/- VIDE CHALLAN NO.22887 DATED:30/06/2017
- 3) THE APPLICANT HAS TO ABIDE BY THE CONDITIONS IMPOSED IN THE WORK ORDER.
- 4) THE WORK ORDER ISSUED VIDE NO: BDA/TPM/PRL 39/2016-17-771 DATED: 28/07/2018

<i>(Signature)</i> 26/07/2018	<i>(Signature)</i> 26/07/2018	<i>(Signature)</i> 26/07/2018	<i>(Signature)</i> 26/07/2018	<i>(Signature)</i> 26/07/2018	<i>(Signature)</i> 26/07/2018	<i>(Signature)</i> 26/07/2018
TOWN PLANNER (BDA)	ASSI DIRECTOR (BDA)	DEPUTY DIRECTOR(EAST) (BDA)	JOINT DIRECTOR (MP) (BDA)	ADL DIRECTOR (BDA)	TOWN PLANNER MEMBER (BDA)	COMMISSIONER (BDA)